



COMPANY INTRODUCES

Seven Star Electric was established in 1995. It is a national high-tech enterprise dedicated to the research, development and production of electric insulation products and high-voltage transmission and distribution products. The main products of the company include ring network cabinets, production and development of smart grid software and hardware (primary and secondary fused column switches, intelligent stations, power clairvoyance, etc.), cable branch boxes, low-voltage complete sets of equipment, cable connectors, cold shrink cable accessories, insulators, lightning arresters, etc. The company has a registered capital of RMB 130 million, fixed assets of RMB 200 million and more than 600 employees. The company has registered capital of 130 million yuan, fixed assets of 200 million yuan and more than 600 employees. 2021, the company will achieve a turnover of 810 million yuan and tax revenue of nearly 30 million yuan. 2022, the annual output value is expected to exceed 1 billion yuan. The company's products have been sold to Vietnam, Philippines, Brazil, South Africa, Singapore, Malaysia and other countries.

In 2022, Quanzhou Tianchi Electric Import & Export Trading Co., Ltd. will be established to serve overseas customers.

TEL:+86-15005059589 Email:Sales1@tianchielectric.com

7 Stars 七星电气
QUANZHOU SEVENSTARS
ELECTRIC CO.,LTD

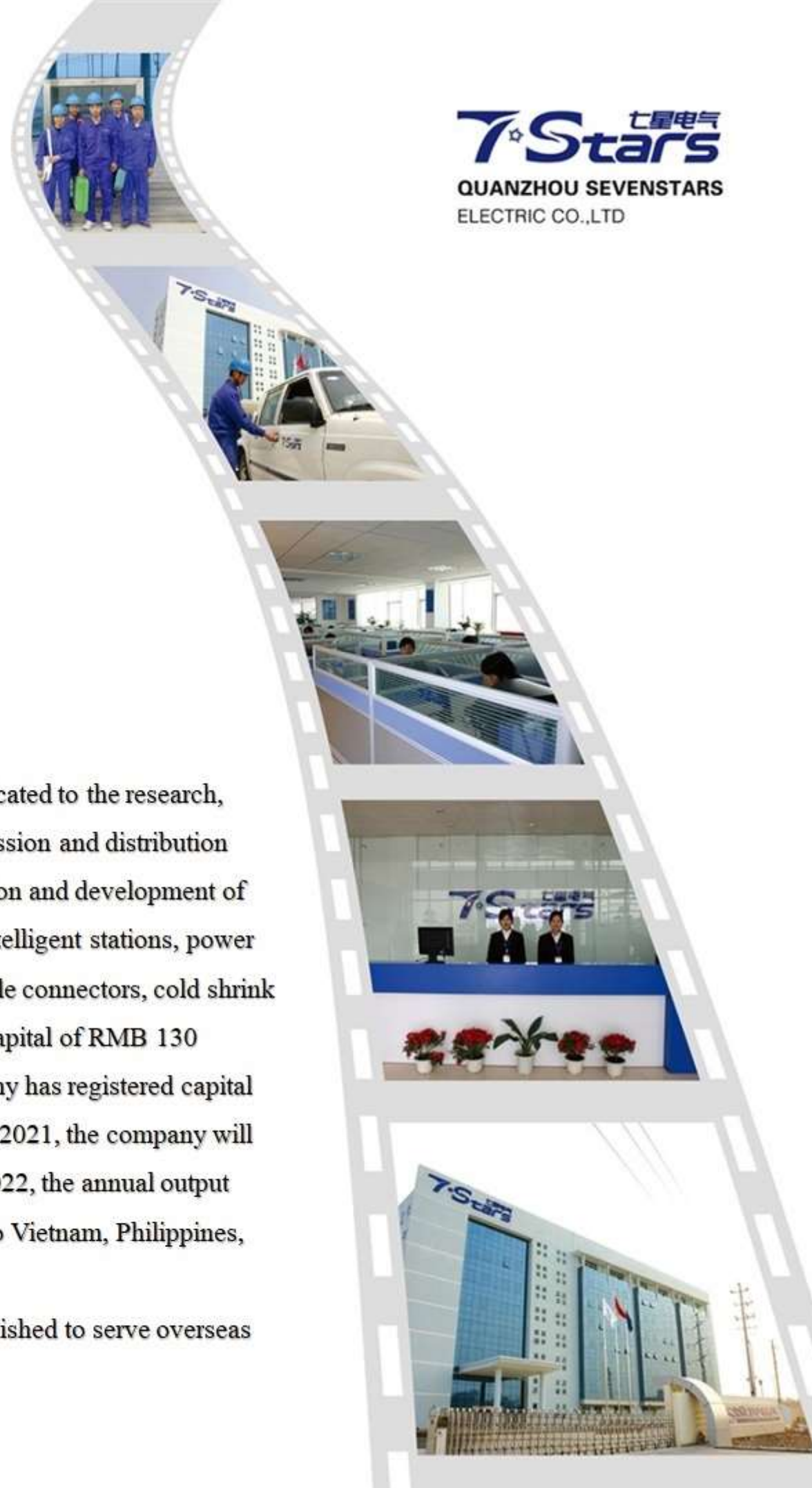

■ SILICONE RUBBER

Properties of LSR (liquid silicone rubber)

- silicone rubber composed of silicone and oxygen has
- both the organic and inorganic properties.
- main properties:
- excellent UV and Ozone resistance
- optimal climate and aging resistance
- temperature ambient - 50°C - 50°C
- high elasticity
- unconfined term for reserve
- constant hydrophobic and transferred property
- excellent burning and temperature resistances
- electrical tracking resistance
- particular environmental protection

Parameters

item	test standard	data
hardness	GB/T2411-1980	40±5
dielectric constant (50Hz)	GB1693-1981	2.5-3.0
tensile strength (MPa)	GB/T528-1992	≥7.5
度tear resistance (kN/m)	GB/T529-1992	≥33
elongation at break (%)	GB/T528-1992	≥550
elongation permanent def. (%)	GB/T528-1992	≤5
volume resistant ratio (Ω • cm)	GB/T1692-1992	1.0×10 ¹³
leakage tracking resistance	GB/T6553-1986	1A4.5

■ CABLE ACCESSORIES

- the stress control units inserted in the insulating tube of accessories relieve effectively the concentration of electrical field at the point of the peeled inner conductive layer of cable. This unit is injected molded to one piece.
- with the advantage of high elasticity and sealed effect the inner diameter of the insulating tube is designed to avail the tighter inserting of cable and ensure gapless interface.
- the design of outer insulation is suitable the IV degrees of contaminated environment
- special design of interval arrangement for umbrella increases not only creepage distance but also improves ability to prevent the flash



PARTICULAR TECHNOLOGY

- advanced technology of prefabricating and expanding
- particular construction to increase the creepage distance
- particular design of stress control – unit

EXPENSIVE USE

suitable for several different diameter of cable conductor with one size,applicable in various regions such as salt–fog, high altitude, heavy contaminated,freezing and sweltering moist areas, applicable in divisions of power supply, petrochemistry, steel and railway etc.

SIMPLE INSTALLATION

provides extra a calipers to measure the cutting off dimension and increase the accuracy of installation, provides extra three cold shrinkable insulating tubes and a spread cap for three cores cable, convenient for installation with pushing – on or expanding technique.

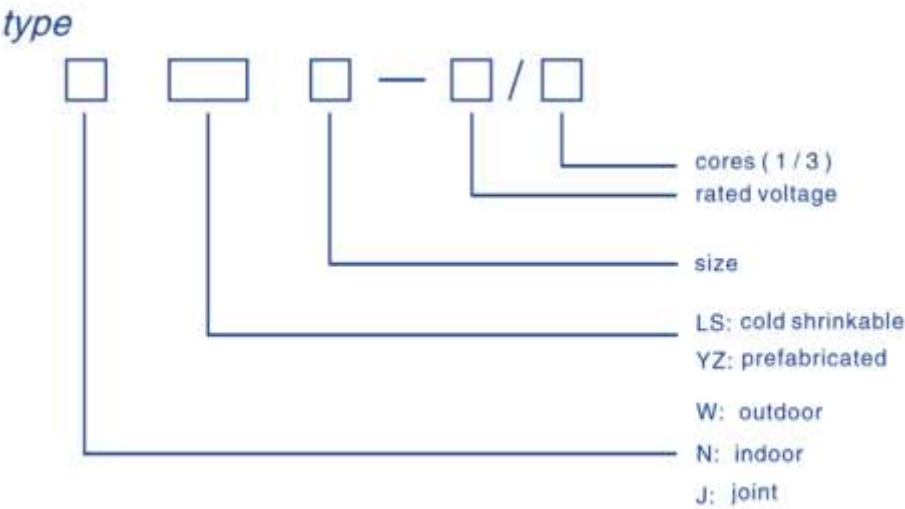

PARAMETERS

test item	unit	test result		
		10kV	20kV	35kV
voltage withstand	kV/5min	39	54	117
partial discharging	pC	≤10/15 kV	≤1 0/20 kV	≤1 0/45kV
load cycle test	kV 500h	23	30	65
impulse voltage withstand	kV	95	125	200
DC voltage withstand	kV/15min	35	48	104

■ NYZ 10kV INDOOR TERMINATION

conductor section (mm²)	type		strength range (mm)	
	single core	three cores	Min.	Max.
25	NYZ1–10/1	NYZ1–10/3	16.00	20.00
35				
50				
70	NYZ2–10/1	NYZ2–10/3	20.00	23.00
95				
120	NYZ3–10/1	NYZ3–10/3	23.00	26.00
150				
185	NYZ4–10/1	NYZ4–10/3	26.00	30.00
240				
300	NYZ5–10/1	NYZ5–10/3	30.00	36.00
400				



■ WYZ 10kV OUTDOOR TERMINATION



conductor section (mm²)	type		strength range (mm)	
	single core	three coress	Min.	Max.
25	WYZ1–10/1	WYZ1–10/3	16.00	20.00
35				
50				
70	WYZ2–10/1	WYZ2–10/3	20.00	23.00
95				
120	WYZ3–10/1	WYZ3–10/3	23.00	26.00
150				
185	WYZ4–10/1	WYZ4–10/3	26.00	30.00
240				
300	WYZ5–10/1	WYZ5–10/3	30.00	36.00
400				

■ NYZ 20kV INDOOR TERMINATION

conductor section (mm ²)	type		strength range (mm)	
	single core	three cores	Min.	Max.
35	NYZ1-20/1	NYZ1-20/3	18.00	22.00
50				
70	NYZ2-20/1	NYZ2-20/3	22.00	25.00
95				
120	NYZ3-20/1	NYZ3-20/3	25.00	28.00
150				
185	NYZ4-20/1	NYZ4-20/3	28.00	32.00
240				
300	NYZ5-20/1	NYZ5-20/3	32.00	37.50
400				



■ NYZ 35kV INDOOR TERMINATION

conductor section (mm ²)	type		strength range (mm)	
	single core	three cores	Min.	Max.
50	NYZ1-35/1	NYZ1-35/3	30.00	33.50
70				
95	NYZ2-35/1	NYZ2-35/3	33.50	36.50
120				
150	NYZ3-35/1	NYZ3-35/3	36.50	40.00
185				
240	NYZ4-35/1	NYZ4-35/3	40.00	44.50
300				
400	NYZ5-35/1	NYZ5-35/3	44.50	50.00
500				



■ NYZ 20kV INDOOR TERMINATION



conductor section (mm ²)	type		strength range (mm)	
	single core	three cores	Min.	Max.
35	WYZ1-20/1	WYZ1-20/3	18.00	22.00
50				
70	WYZ2-20/1	WYZ2-20/3	22.00	25.00
95				
120	NYZ3-20/1	WYZ3-20/3	25.00	28.00
150				
185	WYZ4-20/1	WYZ4-20/3	28.00	32.00
240				
300	WYZ5-20/1	WYZ5-20/3	32.00	37.50
400				

■ WYZ 35kV OUTDOOR TERMINATION



conductor section (mm ²)	type		strength range (mm)	
	single core	three cores	Min.	Max.
50	WYZ1-35/1	WYZ1-35/3	30.00	33.50
70				
95	WYZ2-35/1	WYZ2-35/3	33.50	36.50
120				
150	WYZ3-35/1	WYZ3-35/3	36.50	40.00
185				
240	WYZ4-35/1	WYZ4-35/3	40.00	44.50
300				
400	WYZ5-35/1	WYZ5-35/3	44.50	50.00
500				

■ NYZ 35kV THREE CORES CABLE PREFABRICATED INDOOR TERMINATION

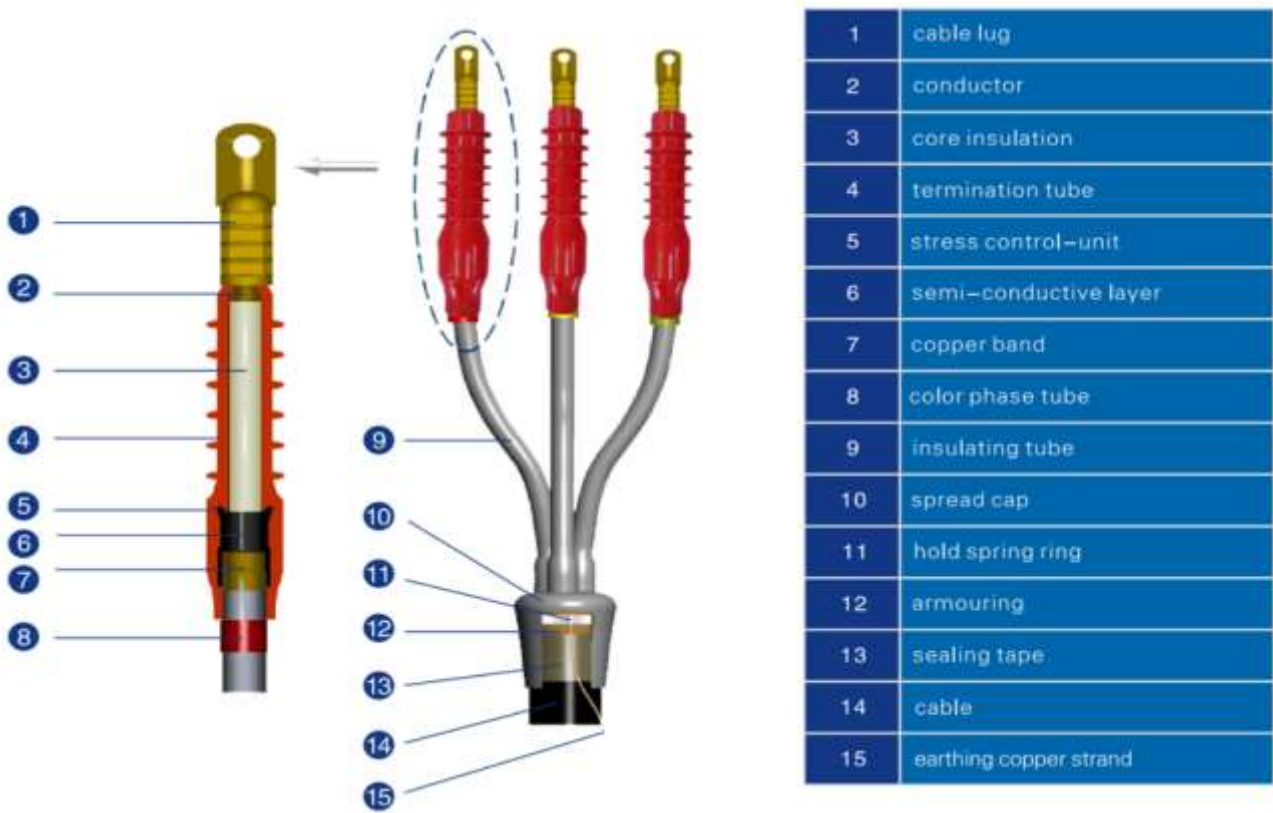

SCOPE OF DELIVERY

item	unit	amount	item	unit	amount
indoor termination	piece	3	color phase tub	piece	3
cable lug	piece	3	insulating tube	piece	3
hold spring ring	piece	2	earthing copper strand	piece	1
spread cap	piece	1	silicone grease	piece	1
semi-conductive band	piece	1	Cleaning paper	piece	3
PVC band	piece	3	sealing band	piece	1
earthing copper strand	piece	1	sandpaper	piece	2

■ JYZ 10 - 35kV PREFABRICATE CABLE JOINT

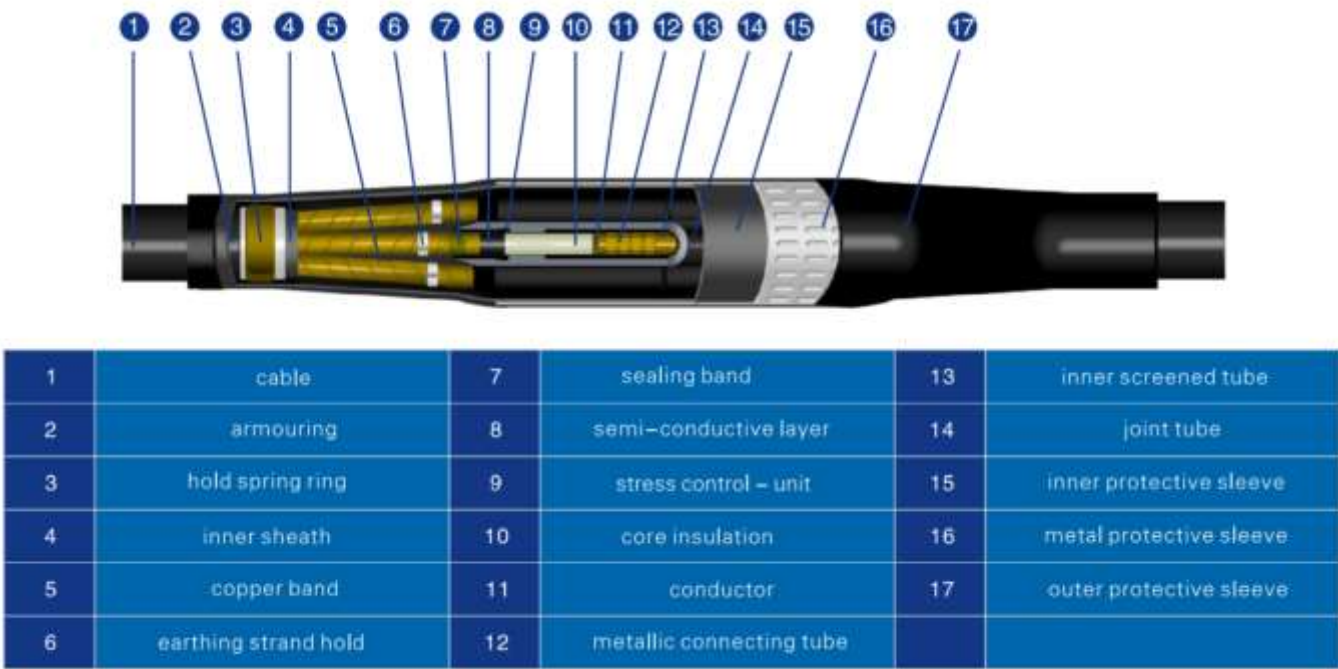

JYZ Cable Joint Specification Sheet

conductor section (mm ²)	type		strength range(mm)	
	single core	three core	Min.	Max.
JYZ 10kV				
25, 35, 50	JYZ1-10/1	JYZ1-10/3	16.00	20.00
70, 95	JYZ2-10/1	JYZ2-10/3	20.00	23.00
120, 150	JYZ3-10/1	JYZ3-10/3	23.00	26.00
185, 240	JYZ4-10/1	JYZ4-10/3	26.00	30.00
300, 400	JYZ5-10/1	JYZ5-10/3	30.00	36.00
JYZ 20kV				
35, 50	JYZ1-20/1	JYZ1-20/3	18.00	22.00
70, 95	JYZ2-20/1	JYZ2-20/3	22.00	25.00
120, 150	JYZ3-20/1	JYZ3-20/3	25.00	28.00
185, 240	JYZ4-20/1	JYZ4-20/3	28.00	32.00
300, 400	JYZ5-20/1	JYZ5-20/3	32.00	37.50
JYZ 35kV				
50, 70	JYZ1-35/1	JYZ1-35/3	30.00	33.50
95, 120	JYZ2-35/1	JYZ2-35/3	33.50	36.50
150, 185	JYZ3-35/1	JYZ3-35/3	36.50	40.00
240, 300	JYZ4-35/1	JYZ4-35/3	40.00	44.50
400, 500	JYZ5-35/1	JYZ5-35/3	44.50	50.00

■ NLS 10kV INDOOR TERMINATION

conductor section (mm ²)	type		strength range (mm)	
	single core	three cores	Min.	Max.
25	NLS1-10/1	NLS1-10/3	16.00	20.00
35				
50				
70	NLS2-10/1	NLS2-10/3	20.00	24.50
95				
120				
150	NLS3-10/1	NLS3-10/3	24.50	30.00
185				
240				
300	NLS4-10/1	NLS4-10/3	30.00	36.00
400				



■ NLS 20kV INDOOR TERMINATION

conductor section (mm ²)	type		strength range (mm)	
	single core	three cores	Min.	Max.
35	NLS1-20/1	NLS1-20/3	18.00	22.00
50				
70				
95	NLS2-20/1	NLS2-20/3	22.00	26.50
120				
150				
185	NLS3-20/1	NLS3-20/3	26.50	32.00
240				
300				
400	NLS4-20/1	NLS4-20/3	32.00	37.50



■ WLS 10kV OUTDOOR TERMINATION



conductor section (mm ²)	type		strength range (mm)	
	single core	three cores	Min.	Max.
25	WLS1-10/1	WLS1-10/3	16.00	20.00
35				
50				
70	WLS2-10/1	WLS2-10/3	20.00	24.50
95				
120				
150	WLS3-10/1	WLS3-10/3	24.50	30.00
185				
240				
300	WLS4-10/1	WLS4-10/3	30.00	36.00
400				

■ WLS 20kV OUTDOOR TERMINATION



conductor section (mm ²)	type		strength range (mm)	
	single core	three cores	Min.	Max.
35	WLS1-20/1	WLS1-20/3	18.00	22.00
50				
70				
95	WLS2-20/1	WLS2-20/3	22.00	26.50
120				
150				
185	WLS3-20/1	WLS3-20/3	26.50	32.00
240				
300				
400	WLS4-20/1	WLS4-20/3	32.00	37.50

■ W(N)LS 35kV OUTDOOR/INDOOR TERMINATION

conductor section (mm ²)	type		strength range (mm)	
	single core	three cores	Min.	Max.
50	NLS1-35/1 WLS1-35/1	NLS1-35/3 WLS1-35/3	30.00	40.00
70				
95				
120				
150				
185	NLS2-35/1 WLS2-35/1	NLS2-35/3 WLS2-35/3	40.00	50.00
240				
300				
400				
500				



■ JLS 10-35KV COLD SHRINKABLE CABLE JOINT

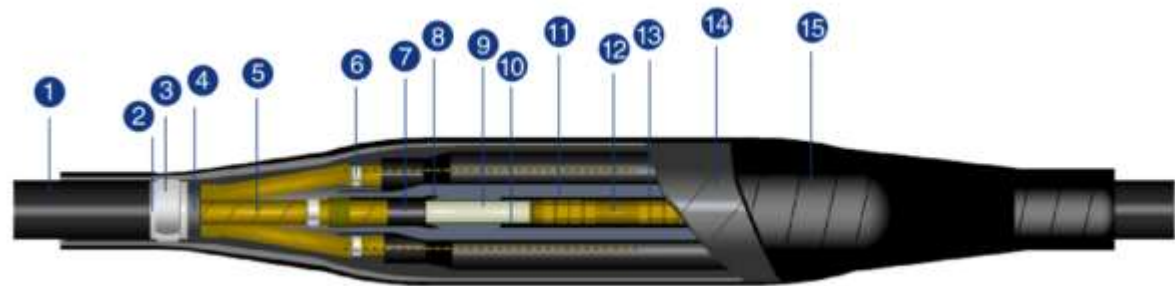

1	outer sheath of cable	6	small hold spring ring	11	joint tube
2	armouring	7	semi-conductive layer	12	copper tube
3	hold spring ring	8	stress control – unit	13	inner protective sleeve
4	inner sheath of cable	9	core insulation	14	metal protective sleeve
5	screened copper – band	10	inner screened tube	15	outer protective sleeve

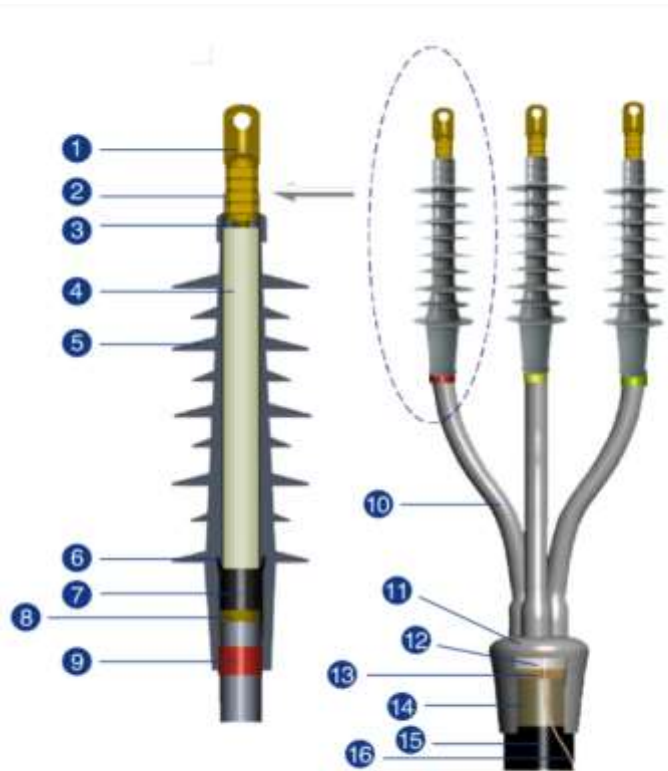

1	cable lug
2	lug cable cap
3	conductor
4	core insulation
5	termination tube
6	stress control – unit
7	semi-conductive layer
8	screened copper band
9	color phase tube
10	insulating tube*
11	Spread cap
12	hold spring ring
13	armouring
14	sealing tape
15	earthing copper-strand
16	cable

■ TOKV COLD SHRINKABLE INSULATING TUBE AND SPREAD

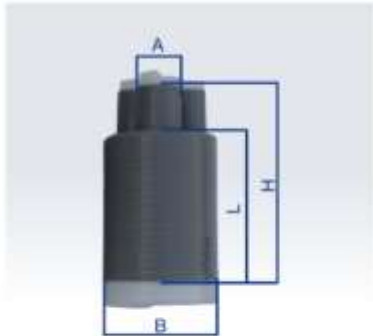

No.	catalog No.	A	B	H	L
1	SSLSd110	38.00	95.00	145.00	195.00
2	SSLSd111	43.00	110.00	145.00	195.00
3	SSLSd112	48.00	120.00	160.00	210.00
4	SSLSd113	53.00	130.00	160.00	210.00

No.	catalog No.	L	A
1	SSLHd110	450.00	38.00
2	SSLHd111	450.00	43.00
3	SSLHd112	450.00	48.00
4	SSLHd113	450.00	53.00



10- 35kV PREFABRICATED CABLE CONNECTORS

STRESS CONE

- the stress control – unit is designed to the geometrical construction
- the diameter of stress cone varies with the size of cable, but the connectors have unique dimension
- the effect of sealing should be improved with inner diameter of stress cone markedly smaller than the core insulation of cable

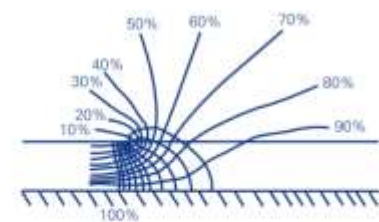

stress distribution without stress control – unit

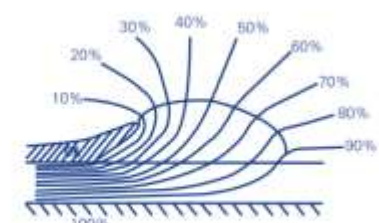

stress distribution with stress control – unit

SCREENED CONSTRUCTION



- the connectors are screened with the conductive materials sprayed on the outer surface of connector
- the outside of connectors are earthed directly with 4mm² cable
- the combination of both stress control – unit designed to the geometrical construction and inner screened tube buffers the stress concentration of the surround electrical field

10- 35kV PREFABRICATED CABLE CONNECTORS

PARAMETERS

test item	unit	test result		
		10kV	20kV	35kV
voltage withstand	kV/5min	39	54	117
partial discharging	pC	≤10/15 kV	≤1 0/20 kV	≤1 0/45kV
load cycle test	kV 500h	23	30	65
impulse voltage withstand	kV	95	125	200
DC voltage withstand	kV/15min	35	48	104

10kV/250A CABLE CONNECTOR

10kV/250A CABLE CONNECTOR



ELBOW CONNECTOR

conductor section (mm ²)	catalog No.	strength range (mm)	
		Min.	Max.
25, 35, 50	KLJC – 4–1	16.00	20.00
70, 95, 120	KLJC – 4–2	19.50	24.50

STRAIGHT CONNECTOR

conductor section (mm ²)	catalog No.	strength range (mm)	
		Min.	Max.
25, 35, 50	KLJZ – 4–1	16.00	20.00
70, 95, 120	KLJZ – 4–2	19.50	24.50



■ KLJH 10kV/630A CABLE SCREENED CONNECTOR



STRESS CONE SIZE

conductor section (mm ²)	catalog No.	strength range (mm)	
		Min.	Max.
25, 35	SSYYd111	16.00	19.00
50, 70, 95, 120	SSYYd112	18.00	24.50
150, 185, 240	SSYYd113	24.00	30.50
300, 400	SSYYd114	30.00	36.00

APPLICATION

- suitable for XLPE power cable with 25 – 400 mm² cross section of single core and three cores Cu or Al conductor
- suitable for the terminate extruded screened cable and other screened form
- suitable for connecting with 10kV transformers, switch– gears and outdoor cable distribution boxes

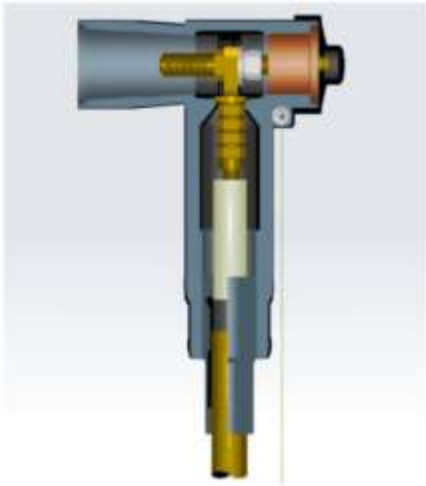

STANDARD

- electrical properties IEC60502, GB/T12706
- bushing – standard: EN50180、EN50181、DIN 47636



KLJH–1 10/630 Combination
KLJK–1 10/630

■ KLJC — 4E 20/kV250AELBOW SCREENED CONNECTOR



CONNECTOR

conductor section (mm ²)	catalog No.	strength range (mm)	
		Min.	Max.
35	KLJC –4E 20/1	18.00	20.50
50	KLJC –4E 20/2	20.00	22.00
70	KLJC –4E 20/3	21.50	23.50
95	KLJC –4E 20/4	23.00	25.00
120	KLJC –4E 20/5	24.50	26.50

MATERIAL AND CONSTRUCTION

- use EPDM as insulating material
- inside with the screening tube and outside with the 3 mm thick injected conductive shell connected to earth
- equipped with the capacitive test point protected by a conductive cap which provides safe operation



■ KLJZ - 4E 20kV/250A STRAIGHT SCREENED CONNECTOR

conductor section (mm ²)	catalog No.	strength range (mm)	
		Min.	Max.
35	KLJZ –4E 20/1	18.00	20.50
50	KLJZ –4E 20/2	20.00	22.00
70	KLJZ –4E 20/3	21.50	23.50
95	KLJZ –4E 20/4	23.00	25.00
120	KLJZ –4E 20/5	24.50	26.50



■ **KLJH 12 20/630 CABLE SCREENED CONNECTOR**



STRESS CONE SIZE

conductor section (mm ²)	catalog No.	strength range (mm)	
		Min.	Max.
35, 50 70, 95, 120	SSYYd211	18.00	26.50
150, 185, 240, 300, 400	SSYYd212	26.00	37.50

APPLICATION

- use the pushing technique to install the accessories
- suitable for single core and three cores 20kV XLPE cable with 35 – 400 mm² Cu or Al conductor section
- suitable for the terminate extruded screened cable other screened form
- suitable for connecting with transformers switchgears and cable distribution boxes etc

KLJK 12 20/630 SCREENED REARCONNECTOR

- designed to separable construction i.e. connector tube and stress cone
- screened fully with the screening tube inside and the sprayed conductive layer connected to earth outside

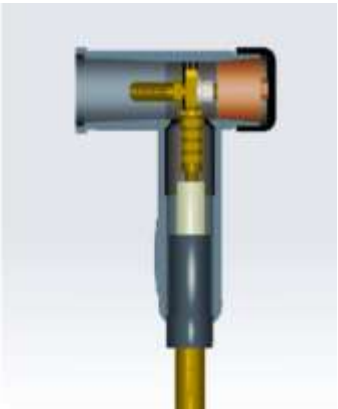

■ **LJH - SJQ 10 UNSCREENED ARRESTER CONNECTOR**



TECHNICAL RATINGS

test item	unit	value
Rated voltage	kV	17
continuous operating voltage	kV	13.6
Residual voltage under 8/20μs impulse current	kV	≤50
DC 1mA ref. voltage	kV	≥25
leakage current under 0.75DC ref. Voltage	μA	≤20
2ms square wave current capacity	A	100
AC withstand for EPDM housing (5min)	kV	39

■ **KLJK - IBQ ARRESTER CONNECTOR**

KLJK – IBQ ARRESTER CONNECTOR

- construction of full insulating, full sealing and full screening, suitable for areas with high salt – fog and heavy pollution
- equipped with devise of anti–explosion and automatic separating
- equipped with pressure release device which functions under 800A to 16 kA fault current
- with the nonlinear resistance slice present the advantages such as low residual voltage, prompt reaction, flat steep wave
- connected with transformers, switches and distribution boxes etc.



KLJK – IBQ 10kV ARRESTER CONNECTOR



LJK – 1BQ 10kV ARRESTER CONNECTOR

■ 15 - 35kV EPDM CABLE CONNECTOR

PARAMETERS

test item	unit	test result		
		15kV	25kV	35kV
voltage withstand	kV/5min	39	54	117
partial discharging	pC	≤10/15 kV	≤1 0/20 kV	≤1 0/45kV
load cycle test	kV 500h	23	30	65
impulse voltage withstand	kV	95	125	200
DC voltage withstand	kV/15min	35	48	104

CHARACTERISTICS

- the construction of complete insulating,, complete screening and complete sealing
- introduced international advanced technology for injecting of insulating EPDM rubber, high electrical performances, reliable and safe operating
- with combining 15kV/600A connector and 15kV /600A rear connector the distance between both centers accounts132mm, 100mm less than with ordinary combination and with combining 15kV /600 ordinary. This construction is suitable for installation in the rigorous space of switchgears or cable distribution boxes
- the accessories with 3 thickness of outer homogeneous screened layer and resistance of earthing < 1000Ω are the international advanced prefabricated connectors –lower partial discharging and high enduring current

■ KLJC — 2 15kV/200A LOADBREAK ELBOW CONNECTOR

connector	conductor section (mm²)	catalog No.	strength range (mm)	
			Min.	Max.
	25	KLJC – 2 15/1	16.00	17.80
	35	KLJC – 2 15/2	16.50	19.00
	50	KLJC – 2 15/3	18.00	20.00
	70	KLJC – 2 15/4	19.50	21.50
	95	KLJC – 2 15/5	21.50	23.50
	120	KLJC – 2 15/6	23.00	24.50

LJ-2/3 15kV/600A/200A LOADBREAK BUSHING EXTENDE

TECHNICAL DATA

test item	unit	value
rated voltage	kV	15
rated current	A	600/200
AC voltage withstand (5min)	kV	39
partial discharge	pC/10kV	≤15
impulse voltage withstand	kV	95
15 min. DC voltage withstand	kV	35



■ KLJC — 2 25kV/200A ELBOW SCREENED CONNECTOR



CONNECTOR SIZE

conductor section (mm ²)	catalog No.	strength range (mm)	
		Min.	Max.
35	KLJC – 4E 25/1	18.00	20.50
50	KLJC – 4E 25/2	20.00	22.00
70	KLJC – 4E 25/3	21.50	23.50
95	KLJC – 4E 25/4	23.00	25.00
120	KLJC – 4E 25/5	24.50	26.50

APPLICATION

- use the pushing technique to install the accessories
- suitable for 25kV single core and three cores XLPE cable of 35~120 mm² Cu or Al conductor section
- suitable for the terminate extruded screened cable.
- full insulation and full sealing suitable for areas with heavy pollution , high humidity and high salt–fog
- suitable for connecting with transformers switchgears and outdoor cable distribution boxes etc



LJ – 2B 25kV/200A BUSHING

electrical properties: IEEE386 IEC60502 GB/T12706

bushing – standard: IEEE386



■ KLJC — 2 25kV/200A ELBOW SCREENED CONNECTOR



STRESS CONE SIZE

conductor section (mm ²)	catalog No.	strength range (mm)	
		Min.	Max.
25	SSYMd131	16.00	17.80
35	SSYMd132	16.50	19.00
50	SSYMd133	18.00	20.00
70	SSYMd134	19.50	21.50
95	SSYMd135	21.5	23.50
120	SSYMd136	23.00	24.50
150	SSYMd137	24.00	26.00
185	SSYMd138	25.50	28.00
240	SSYMd139	27.50	30.50
300	SSYMd140	30.00	33.00
400	SSYMd141	33.00	36.00

APPLICATION

- use the pushing technique to install the accessories
- suitable for 15kV single core and three cores XLPE cable of 25~400 mm² Cu or Al conductor section
- suitable for the terminate extruded screened cable.

STANDARD

electrical properties:IEEE386 IEC60502 GB/T12706

bushing – standard: IEEE386

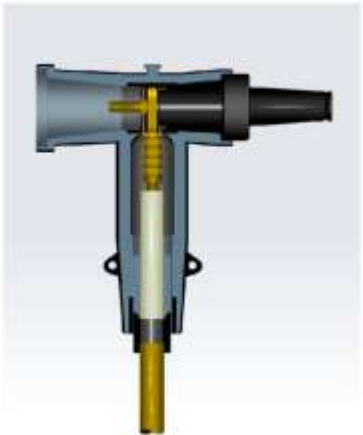

KLJK– 3 15/600
KLJC – 2 15/200 combination



KLJK–3 15/600
HY5W5–17/50 combination

■ OTHER ACCESSORIES



J-2BZ 15kV/200A SOCKET					
1	rated voltage	15kV	4	partial discharge	≤ 10 pC/15kV
2	rated current	200A	5	impulse voltage withstand	95 kV
3	5min AC voltage withstand	39kV	6	15 min. DC voltage withstand	35 kV



LJ-2B2 200A TWO WAYS CONNECTING PLUG					
1	rated voltage	15kV	4	partial discharge	≤10 pC/15kV
2	rated current	200A	5	impulse voltage withstand	95 kV
3	5min AC voltage withstand	39kV	6	15 min. DC voltage withstand	35 kV





HY5W5-17/50 SURGE ELBOW ARRESTER					
1	rated voltage	17kV	4	DC 1mA ref. voltage	≥ 25
2	continuous operating voltage	13.6kV	5	leakage current under 0.75DC ref. Voltage	≤ 20
3	Residual voltage under8/20 μ s impulse current	≤ 50	6	2ms square wave current capacity	100A



KLJC-2J EARTHING ELBOW CONNECTOR						
	1	rated voltage	15kV	4	partial discharge	≤ 10 pC/15kV
	2	rated current	200A	5	impulse voltage withstand	95 kV
	3	5min AC voltage withstand	39kV	6	15 min. DC voltage withstand	35 kV



KLJK – 3 MP 15kV/600A MULTI JUNCTION						
	1	rated voltage	15kV	4	partial discharge	≤ 10 pC/15kV
	2	rated current	600A	5	impulse voltage withstand	95 kV
	3	5min AC voltage withstand	39kV	6	15 min. DC voltage withstand	35 kV





KLJK – 3 IKLJK – 3 MP 15kV 200/KLJK – 3 MP 15kV 200/600A MULTI JUNCTION					
1	rated voltage	15kV	4	partial discharge	≤ 10 pC/15kV
2	rated current	200/600A	5	impulse voltage withstand	95 kV
3	5min AC voltage withstand	39kV	6	15 min. DC voltage withstand	35 kV

■ OTHER ACCESSORIES



KLJK – 3A MP 15kV 200A/600A MULTI JUNCTION						
	1	rated voltage	15kV	4	partial discharge	≤ 10 pC/15kV
	2	rated current	200/600A	5	impulse voltage withstand	95 kV
	3	5min AC voltage withstand	39kV	6	15 min. DC voltage withstand	35 kV



KLJK – 3JM 15kV/200A INSULATING PROTECTIVE CAP						
	1	rated voltage	15kV	4	partial discharge	≤ 10 pC/15kV
	2	rated current	200A	5	impulse voltage withstand	95 kV
	3	5min AC voltage withstand	39kV	6	15 min, DC voltage withstand	35 kV



KLJK – 3JM 15kV/600A INSULATING PROTECTIVE CAP					
1	rated voltage	15kV	4	partial discharge	≦ 10 pC/15kV
2	rated current	600A	5	impulse voltage withstand	95 kV
3	5min AC voltage withstand	39kV	6	15 min. DC voltage withstand	35 kV



KLJ - LTG -2 10kV/630A BUSHING					
1	rated voltage	10kV	4	partial discharge	≤ 10 pC/15kV
2	rated current	630A	5	impulse voltage withstand	95 kV
3	5min AC voltage withstand	39kV	6	15 min. DC voltage withstand	35 kV

	SSST – LT 10kV/630A CONNECTING PLUG					
	1	rated voltage	10kV	4	partial discharge	≤ 10 pC/15kV
	2	rated current	630A	5	impulse voltage withstand	95 kV
	3	5min AC voltage withstand	39kV	6	15 min. DC voltage withstand	35 kV



KLJ – LTG –2 15kV/600 A BUSHING					
1	rated voltage	15kV	4	partial discharge	≤ 10 pC/15kV
2	rated current	600A	5	impulse voltage withstand	95 kV
3	5min AC voltage withstand	39kV	6	15 min. DC voltage withstand	35 kV